



# TM11 Full-LED Tail light

The light of the future

# Innovative lighting system solutions

## Modern Light- and LED technology

### The compact and modern 7-function tail light from ERMAX

As highlighted the full-LED tail light from Ermax offers a thin design, modern dynamic indicator light, impact-resistant lens and integration of all legal control units.

The intelligent and up to date control unit of the Ermax TM11 makes the universal connection of the tail light to any truck wanted possible – without failure warnings. This is also valid for the indicator failure control – and the brake light control.

The indicator light function in the side markers, lights simultaneously with the tail light according to ECE 48. This function is fully integrated in the TM11 tail light.

Superior durability, modern functionality and a modern design, come together in the Ermax TM11 tail light and making it a real highlight.

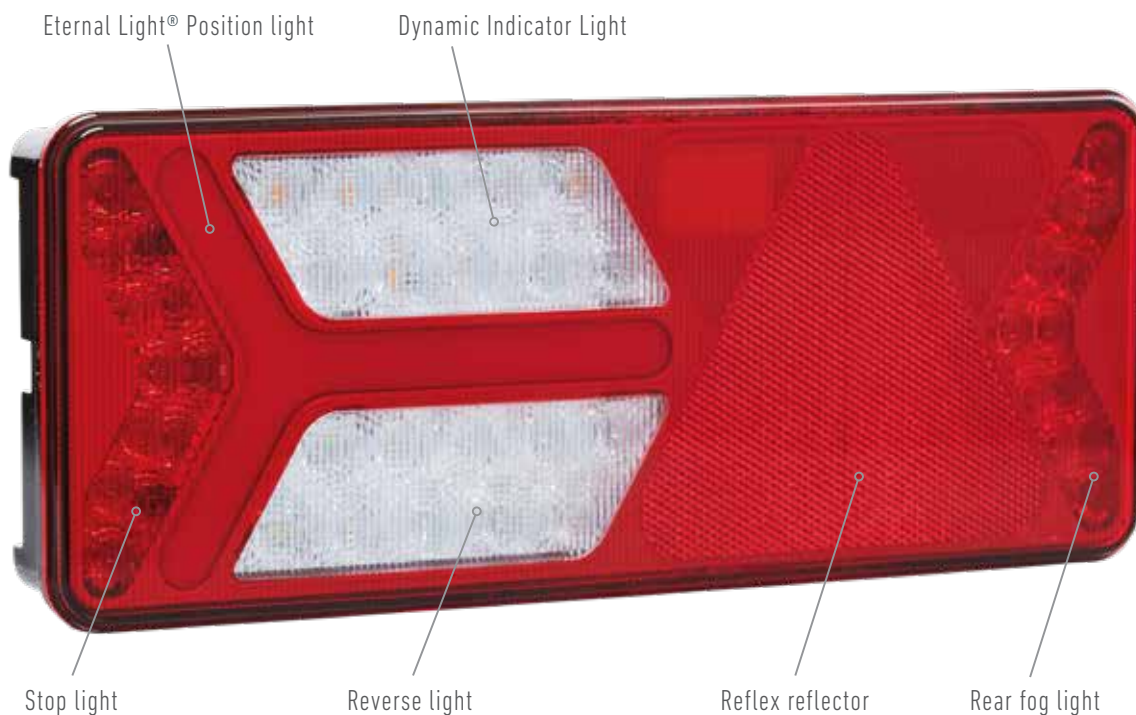

### Ermax is your reliable partner for high quality lighting systems

Ermax® is the exclusive brand for lighting systems of high quality and complete cable systems for vehicles. With innovative research and development Ermax® has strengthened the position as significant OEM manufacturer based on the 70 years of experience within the electric and lighting segment. The Ermax® product programme is available for OEM as well as aftermarket.

# TM11 Full-LED Tail light



The light for standard vehicles

## Highlights

- Unbreakable - Impact-resistant lens made of polycarbonate
- Multi voltage 12/24V
- Modern dynamic indicator light
- Built-in indicator failure control according to ECE 48 - compatible with all makes and year of EU Trucks\*
- Built-in stop failure control according to ECE 48 - compatible with all makes and year of EU Trucks\*
- Built-in control unit for flashing side marker lights (SIMAC®) according to ECE 48 supp. 06 (since november 2017)
- Certified according to all relevant standards and regulations in Europe

\* September 2018

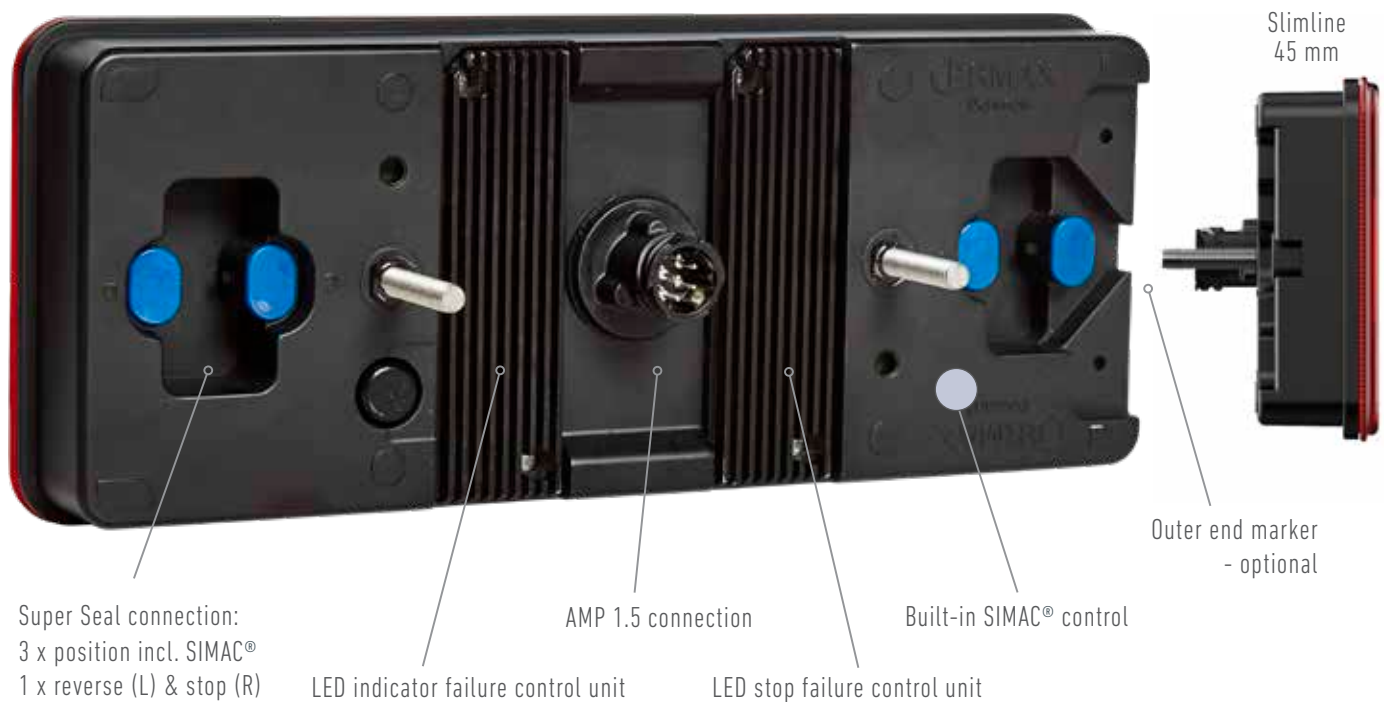

## TECHNICAL FEATURES:

- Multi voltage 12V/24V
- Polycarbonate lens
- 7 pole AMP 1.5 connection
- Bolt hole distance: 152 mm / M8
- Approvals: ECE, EMC, ADR
- IP69K rating



Brands of the BPW Group:



**ERMAX**®

**HBN-Teknik** A/S

**HESTAL**®

**idem**  
telematics

September 2018 - Version 1.0

 **ERMAX**®  
"Light Made Heavy Duty"

Transport-Teknik A/S  
Vranderupvej 2 • DK-6000 Kolding  
Bjerringbrovej 116 • DK-2610 Rødovre  
Tel. +45 7552 5200 • Tel. +45 3969 6800  
[www.ermax.dk](http://www.ermax.dk)